



IOUD - institute of urban design

825106 PJ Entwerfen 1

Univ.-Prof. Dipl.-Ing. Dr. Peter Trummer
Janna Eberharter, MArch
Luca Zanarini, MArch

WHAT CITY LIES IN AN ICONIC BUILDING

INTRO:

The course discusses the role of architectural typologies in creating cohesive urban environments. By transforming iconic dwelling designs (icons) into urban hybrids, the course`s objective is to re-discover hidden potentials re-immagining how a city can look/function.

Through a mix of theoretical analysis and practical design exercises, students will develop hybrid structures that integrate small-scale architecture with large-scale urbanity and infrastructure.

Abstract:

The design course `What City Lies In An Iconic Building` delves into the crucial concept of typologies in architecture. Typology refers to the classification of buildings based on their function and form, serving as a foundational element in architectural design. Understanding and utilizing typologies is essential for architects as it allows for the design of cohesive and functional urban environments.

The seminar explores the transformation of iconic residential designs (by renowned architects) into innovative urban hybrids, inspired by the concept of O.M.A.'s hyperbuilding. By reimagining these dwellings within the context of dense, multi-functional urban structures, the seminar aims to challenge conventional architectural boundaries and address the evolving needs of contemporary cities.

Participants will examine key architectural reference projects, dissect their core design principles, and explore strategies to integrate those principles into large-scale urban forms. Through a blend of theoretical analysis and practical design exercises, the seminar seeks to cultivate a new approach to urbanism — one that merges the intimacy of dwelling spaces with the complexity of urban infrastructure. The course focuses on integrating modernist architectural designs into hybrid urban structures. Students will explore how small-scale architecture can influence larger cityscapes, discovering how individual dwellings can inform and transform broader urban typologies.

The course is structured into four phases. In the first phase, students will analyze and 3D model iconic buildings, gradually building a comprehensive library of architectural icons. In the second phase, each group of 2 students will select ten icons from the library and develop four distinct typologies based on these selections. Ultimately, students will design their own hybrid structures, synthesizing the four typologies. These hybrids will be enhanced with essential urban amenities such as transportation, parks, and leisure facilities, creating a new form of urban structure.

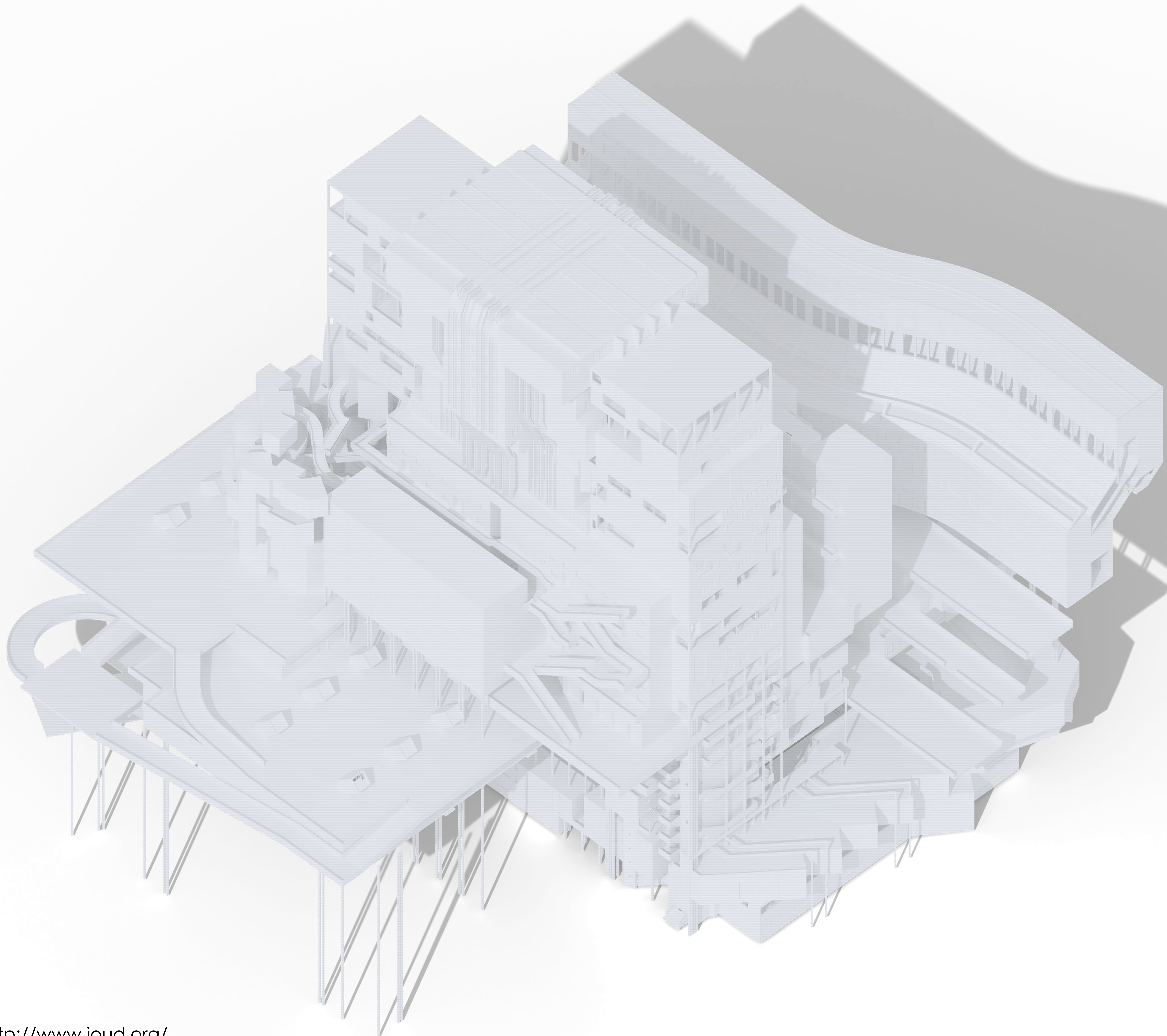

SEMESTER PREVIEW:

Pin-Up after every phase

PHASE 1

analysis + modeling (icons)

PHASE 2

design 4 different typologies (by using the icons)

PHASE 3

create a hybrid city block out of the typologies

PHASE 4

add urban amenities to finalize the hybrid design

Organization:

Students will start their analysis in individual work and continue working in groups of two after the first Pin-Up. The idea is to accumulate a bigger library of icons while ensuring each student gains hands-on experience with 3D modeling, rendering and architectural analysis.

Methodology:

The methodology will center around developing a creative design project, supported by a strong foundation in analysis and theory. Throughout the course, students will not only engage in the design process but also acquire essential skills in rendering (Blender), 3D modeling (Rhino), and visual representation. These technical abilities will be integrated with theoretical knowledge, allowing students to create designs that are both innovative and conceptually grounded.

Please bring your laptop with Blender and Rhino installed to every meeting!

LIST OF ICONIC BUILDINGS (ICONS):

that a collection of known spatial arrangements holds potential to generate new types of spaces

Le Corbusier House Weissenhofsiedlung, Le Corbusier
Gropius House, Walter Gropius
Villa Savoy, Le Corbusier
Villa Bordeaux, Rem Koolhaas
Wood House, Eileen Grey
Villa Tugendhat, Mies van der Rohe
House IV, Peter Eisenman
Wall House, John Hejduk
Slow House, Diller Scofidio,
Esherik House, Luis Kahn
Villa dal Ava, Rem Koolhaas
4x4 house, Tadao Ando
Villa Moller, Adolf Loos
Miller House, Eero Saarinen
Casa das Canoas, Oscar Niemeyer
Chuey House, Richard Neutra
Summer House, IM Pei
Esprit Nouveau, Le Corbusier
Satzman House, Richard Meier
Rogers House, Richard Rogers
Bloom House, Greg Lynn
Ex of In, Steven Holl
St. Joseph House, Tschapeller
Malibu House, Tadao Ando
Hooper House, Marcel Breuer
Kaufmann House, Richard Neutra
Haus M, Hermann Czech

TO BE CONTINUED ..

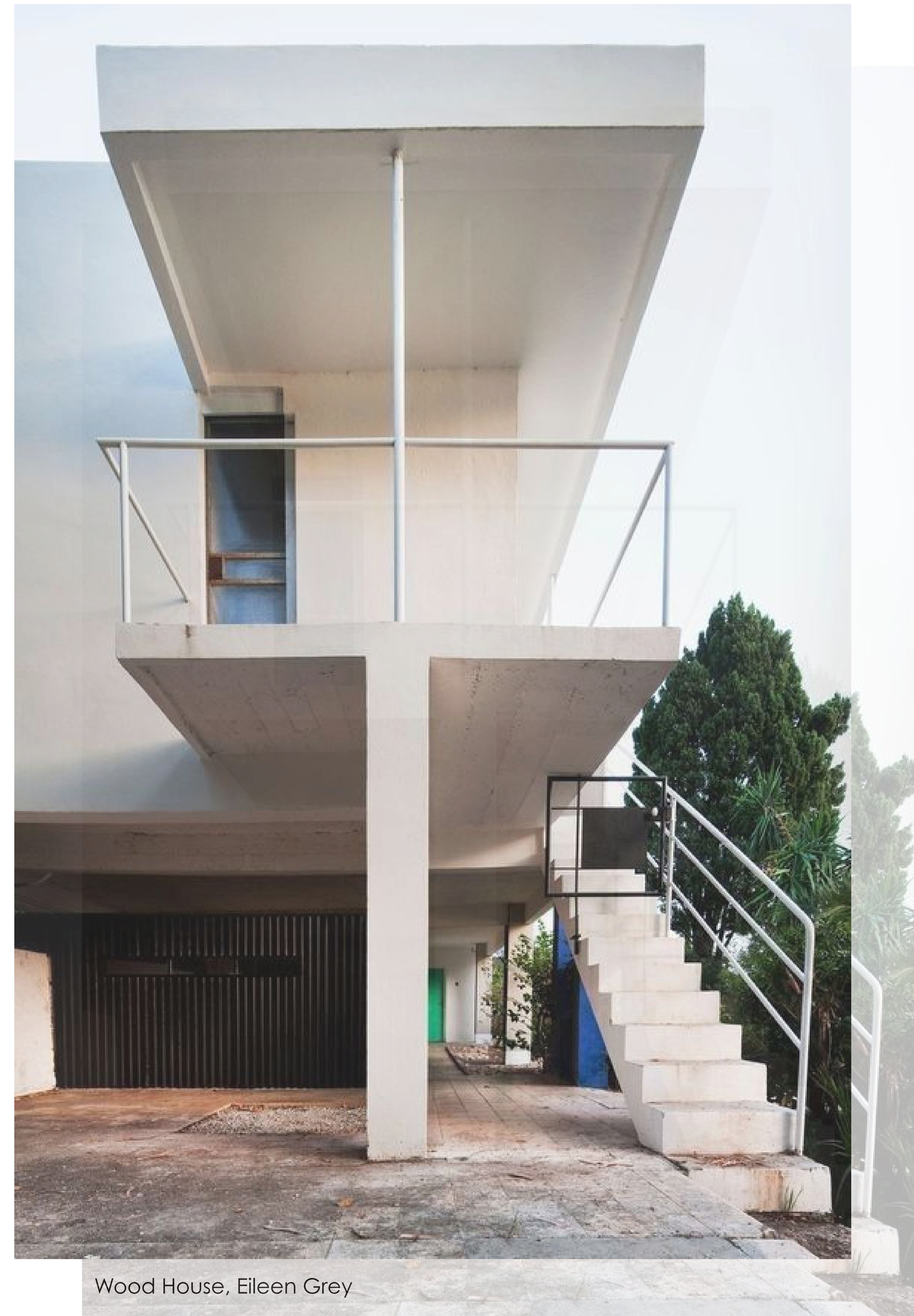

Wood House, Eileen Grey



FIRST MEETING:

Wednesday, 2nd October, 10 AM

at IOUD, 3rd floor

looking forward to seeing you!

following meetings every
wednesday, 10 AM

Dates:

02.10 Kick-Off

09.10

16.10 Pin Up

23.10

29.10

06.11

13.11

20.11

27.11 Pin Up

04.12

11.12

X-Mas Holidays

08.01 Pin Up

15.01

22.01

29.01 Finals

tbc.